

# SERVICING MANUAL



---

## Approach Masts

200mm - 12000mm

## Single Light 60mm Servicing Information

Occasional maintenance of the mast should be undertaken; this should coincide with the servicing of the light.

### Servicing

- » Our glassfibre / aluminium masts are maintenance free.
- » Ensure that the tripod base is securely attached to the ground rods - tighten nuts if required.
- » Ensure that the frangible coupling remains secure in the tripod base, tighten if required.
- » Ensure that the mast is correctly level.
- » Check for any movement in the mast or the coupling, if required tighten the small bolts and lock nuts on the frangible coupling to secure the mast firmly in place.

### Tools Required

- » Adjustable Spanner

In the unlikely event of a part failing on this product or if a replacement is required, please revert to the parts list below.

Specification	Part Code
Tripod Base	P510
Frangible Coupling	P511
Hex Bolt	B0001
Lock Nut	B0002
Shim (Aluminium)	B0003

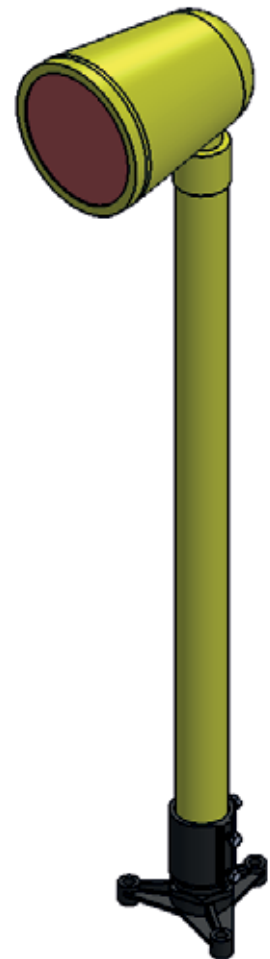

## Single Light 125mm Servicing Information

Occasional maintenance of the mast should be undertaken; this should coincide with the servicing of the light.

### Lowering the Mast

To lower the mast, remove the four full nuts on the top of the base plate and carefully hinge the mast down.

### Servicing

- » Our glassfibre masts are maintenance free.
- » Ensure that the ground plate is securely attached to the ground rods and all nuts above and below the ground plate are tight.
- » Perform a check on the upper full nuts which secure the mast in the vertical position and tighten if necessary.
- » Check that the hinge pin which joins the mast base plate to the ground plate is secure.
- » Ensure there is no movement on the mast cap and the securing screws are tight.
- » Check the large nuts on the light height adjuster are tight and the lock washers are correctly engaged – this will prevent any movement on the light caused by wind vibration.

### Raising the Mast

To raise the mast, carefully hinge it up vertically until it meets the washers and secure in place using the four full nuts.

### Torquing

We recommend that all nuts are regularly check torqued to ensure they are correctly tightened, see 'General Information' leaflet for torque figures.

### Tools Required

- » Adjustable Spanner
- » Allen Key (3mm)

In the unlikely event of a part failing on this product or if a replacement is required, please revert to the parts list below.

Specification	Part Code
Ground Plate	P205
Lamp Adjuster	P314
Mast Cap	P503
Mast	P505
Lock Washer (M30)	B0007
Anchor Nut (M4.8 x 40mm)	B0048
Washer (40mm)	B0049
Hexagon Lock Nut (M30)	B0027



## Single Light 180mm Servicing Information

Occasional maintenance of the mast should be undertaken; this should coincide with the servicing of the light.

### Lowering the Mast

To lower the mast, remove the four large bolts in the top of the base plate and lower the mast gradually. This procedure should only be undertaken with a minimum of two people. Ensure the mast is carefully 'walked' down and rested on a stand.

Masts above 6m should be raised and lowered using the winch system. (See Winch Operation & Safety Information.)

### Servicing

- » Our glass fibre masts are maintenance free.
- » Check the ground plate is securely attached to the ground rods and all nuts are tight.
- » Check that the hinge pin which joins the mast base plate to the ground plate is secure.
- » Ensure there is no movement on the mast cap and the securing screws are tight.
- » Check the large nuts on the light height adjuster are tight and the lock washers are correctly engaged – this will prevent any movement on the light caused by wind vibration.

### Raising the Mast

Walk it up from the top and push it onto the ground plate allowing the holes in the base plate to align with the threaded resting blocks. Secure the mast in place using the large bolts and washers, ensure they are correctly tightened.

### Torquing

We recommend that all nuts are regularly check torqued to ensure they are correctly tightened, see 'General Information' leaflet for torque figures.

### Tools Required

- » Adjustable Spanner
- » Allen Key (5mm) & (6mm)

In the unlikely event of a part failing on this product or if a replacement is required, please revert to the parts list below.

Specification	Part Code
Ground Plate (400mm x 400mm)	P206
Extended Top Cap	P313
Lamp Adjuster	P314
Mast Cap	P502
Mast	P506
Washer (8mm)	B0001
Washer (10mm)	B0002
Lock Washer (M30)	B0007
Nyloc Nut (M10)	B0024
Hexagon Lock Nut (M30)	B0027
Button Head Screw (M8 x 20mm)	B0041
Spring Washer (8mm)	B0042
Button Head Screw (M10 x 35mm)	B0043

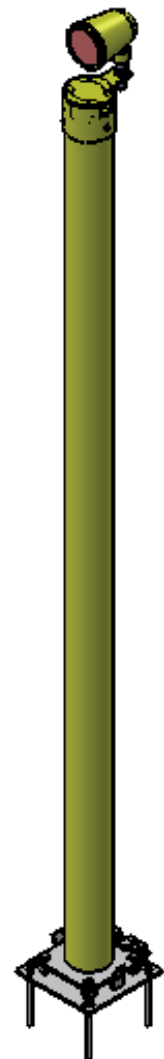

## Multiple Light 180mm Servicing Information

Occasional maintenance of the mast should be undertaken; this should coincide with the servicing of the light.

Cross Arm masts above 6m should be raised and lowered using the winch system. [See Winch Operation & Safety Information.]

### Servicing

- » Our glass fibre masts are maintenance free.
- » Check that the ground plate is securely attached to the ground rods and all nuts are tight.
- » Check that the hinge pin which joins the mast base plate to the ground plate is secure.
- » Ensure there is no movement on the mast cap and the securing screws are tight.
- » Check the top disk for security of attachment and that the 4 securing screws are tight.
- » The cross arms are manufactured from glass fibre and are designed to be maintenance free.
- » Check that all nuts and bolts of the upper and lower support arm brackets are secure.
- » Ensure that the light brackets are correctly located and free from movement.
- » Check the large nuts on the light height adjuster are tight and the lock washers are correctly engaged – this will prevent any movement on the light caused by wind vibration.
- » Once raised, replace the four M20 securing bolts.

### Torquing

We recommend that all nuts are regularly check torqued to ensure they are correctly tightened, see 'General Information' leaflet for torque figures.

### Tools Required

- » Ring Spanner (30mm)
- » Allen Key (5mm) & (6mm)
- » Socket Spanner (13mm), (17mm) & (19mm)

In the unlikely event of a part failing on this product or if a replacement is required, please revert to the parts list below.

Specification	Part Code
Bottom Support Arm Bracket	P200
Cross Arm Support Bracket	P202
Light Bracket	P203
Ground Plate (400mm x 400mm)	P206
Standard Top Cap	P312
Extended Top Cap	P313
Lamp Adjuster	P314
Mast Cap	P502
Mast	P506
Cross Arm (1700mm)	P507
Cross Arm Support (610mm)	P508
Washer (8mm)	B0001
Washer (10mm)	B0002
Lock Washer (M30)	B0007
Nyloc Nut (M10)	B0024
Hexagon Lock Nut (M30)	B0027
Tube Insert (50mm x 50mm)	B0028
Button Head Screw (M8 x 20mm)	B0041
Spring Washer (8mm)	B0042
Button Head Screw (M10 x 35mm)	B0043

